

Recommended P.C.B Layout
General Tolerance±0.05

■ Specifications :

- Voltage rating: 250V AC / DC
- Current rating: 5A AC / DC
- Withstanding voltage: 1000V AC/minute
- Temperature range: -25°C~+85°C
- Insulation resistance: ≥1000MΩ
- Contact resistance: ≤10mΩ
- After environmental testing: ≤20mΩ

3025 W V X-XX C-XX SN XX
① ② ③ ④ ⑤ ⑥ ⑦ ⑧ ⑨

- ① Series No.
- ② Category: W-wafer
- ③ Welding Board Angle: V- Straight 180°
- ④ Welding Way: Blank-DIP
- ⑤ Row No.-Pin No.: XX-02P~12P
- ⑥ Plug the Pin & Special No.: C-With Harpoon
- ⑦ Material: N0-PA66 94V-0; LCP-LCP 94V-0
- ⑧ Planting Category: SN-Bright tin plating
- ⑨ Color: Blank-Natural Color

Poles	Dimensions(mm)		Poles	Dimensions(mm)	
	A	B		A	B
02	3.00	9.65	08	21.00	27.65
03	6.00	12.65	09	24.00	30.65
04	9.00	15.65	10	27.00	33.65
05	12.00	18.65	11	30.00	36.65
06	15.00	21.65	12	33.00	39.65
07	18.00	24.65			

3025WV-XXC-N0SN	PA66 UL 94V-0	Brass	Tin-Plated	3025H
3025WV-XXC-LPSN	LCP UL 94V-0			
PART NO	Material	Material(Pin)	Finish(Pin)	Mates With ADZL Housing

GENERAL TOLERANCE

X	±0.30
.XX	±0.20
.XXX	±0.10

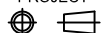

PART NO. 3025WV-XXC-XXSN			
TITLE 3.00 mm Crimp Style Connectors			
UNIT MM	SCALE 1:1	NUMBER A-016	REV E

DATE	OLD REV	NEW REV	ECN	DESCRIPTION	CHECK	APPROVAL	PROJECT
							

APPROVAL	CHECK	DRAWN	DATA
Ken	Wisely He	Allen	2007/05/03

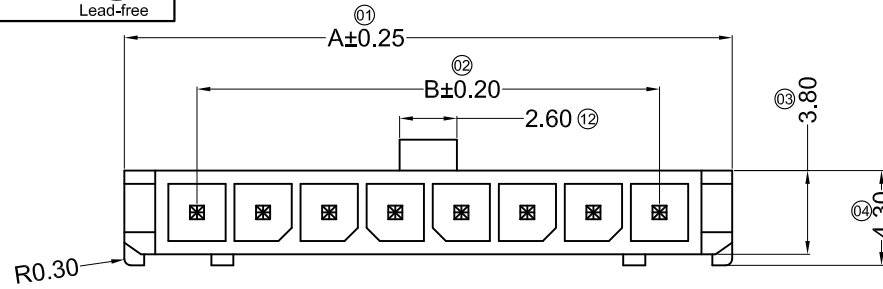

■ Specifications :

- Voltage rating: 250V AC / DC
- Current rating: 5A AC / DC
- Withstanding voltage: 1500V AC/minute
- Temperature range: -25°C~+85°C
- Insulation resistance:≥1000MΩ
- Contact resistance: ≤10mΩ
- After environmental testing: ≤20mΩ
- Mates With ADZL Housing: 3025HM-XX

3025 W V XX X X- XX XX XX - 01

- ① Series No.
- ② Category: W-wafer
- ③ Welding Board Angle: V- Straight 180°
- ④ Row No.-Pin No.: XX-02P~12P
- ⑤ Plug the Pin & Special No.: K- With Kink
- ⑥ Plastic shape & Special No.:W-Column Free
- ⑦ Material: N0-PA66 94V-0 ; LP-LCP 94V-0
- ⑧ Planting Category: SN-Bright tin plating V01-Gold Flash
- ⑨ Color: Blank-Natural Color
- ⑩ Mold No./Mark/Special No.

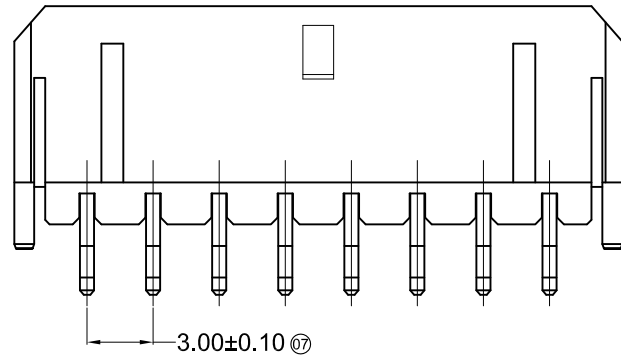

3025WV-XXK-XXXXX-01

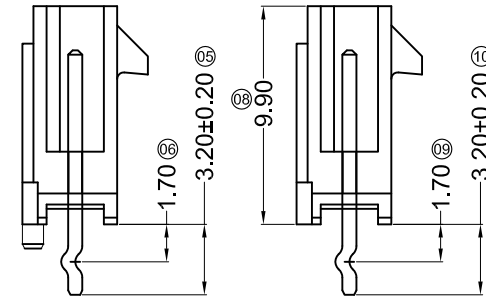

3025WV-XXKW-XXXXX-01

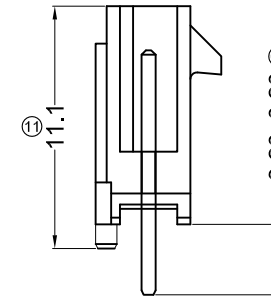

3025WV-XX-XXXXX-01

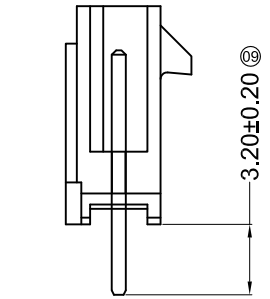

3025WV-XXW-XXXXX-01

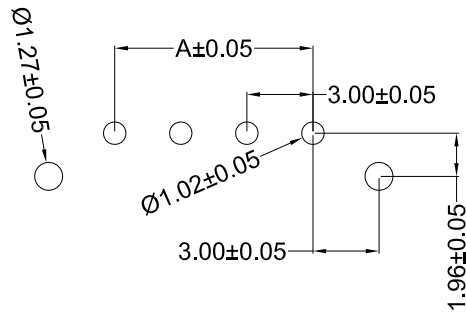

P.C.B LAYOUT

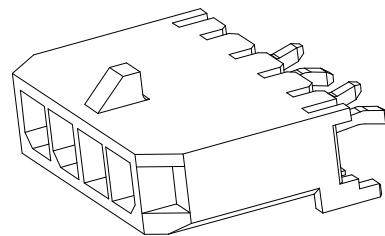

Positions	Dimension	
	A	B
2	9.60	3.00
3	12.60	6.00
4	15.60	9.00
5	18.60	12.00
6	21.60	15.00
7	24.60	18.00
8	27.60	21.00
9	30.60	24.00
10	33.60	27.00
11	36.60	30.00
12	39.60	33.00

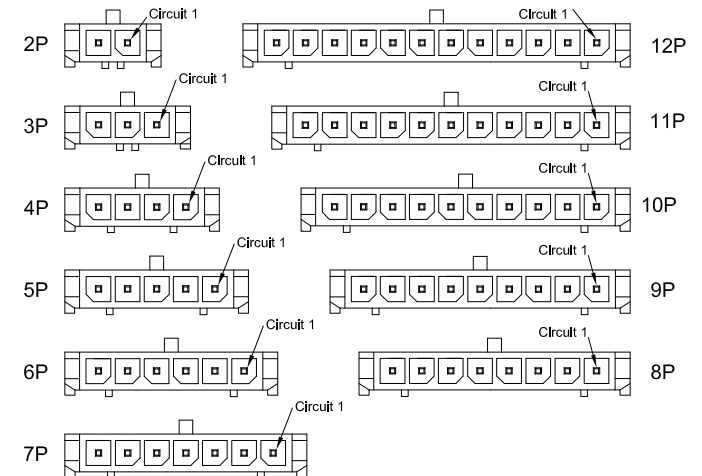

GENERAL TOLERANCE	
.X	±0.30
.XX	±0.20
.XXX	±0.10

东莞市思量连接器有限公司
DONGGUAN ADZL CONNECTORS CO.,LTD.

PART NO. 3025WV-XXXX-XXXXX-01

TITLE 3.00mm Crimp Style Connectors

PROJECT

APPROVAL	CHECK	DRAWN	DATE
Ken	Zhao Hong	Allen	2022/12/10

UNIT	SCALE	NUMBER	REV
MM	1:1		C

DATE	OLD REV	NEW REV	ECN	DESCRIPTION	CHECK	APPROVAL
------	---------	---------	-----	-------------	-------	----------

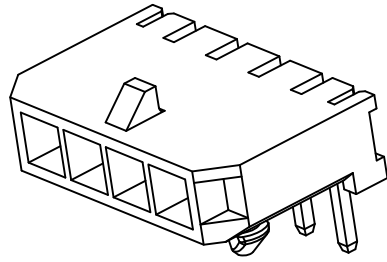
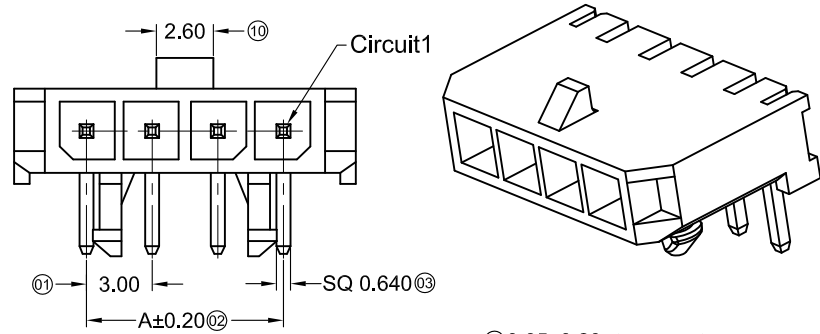

■ Specifications :

- Voltage rating: 250V AC / DC
- Current rating: 5A AC / DC
- Withstanding voltage: 1500V AC/minute
- Temperature range: -25°C~+85°C
- Insulation resistance: ≥1000MΩ
- Contact resistance: ≤10mΩ
- After environmental testing: ≤20mΩ
- Mates With ADZL Housing: 3025HM-XX

3025 W R XX X X- XX XX XX - 01

- ① ② ③ ④ ⑤ ⑥ ⑦ ⑧ ⑨ ⑩

- ① Series No.
- ② Category: W-wafer
- ③ Welding Board Angle: R- Straight 90°
- ④ Row No.-Pin No.: XX-02P~12P
- ⑤ Plug the Pin & Special No.:
- ⑥ Plastic shape & Special No.:W-Column Free
- ⑦ Material: N0-PA66 94V-0 ; LP-LCP 94V-0
- ⑧ Planting Category: SN-Bright tin plating
V01-Gold Flash
- ⑨ Color: Blank-Natural Color
- ⑩ Mold No./Mark/Special No.

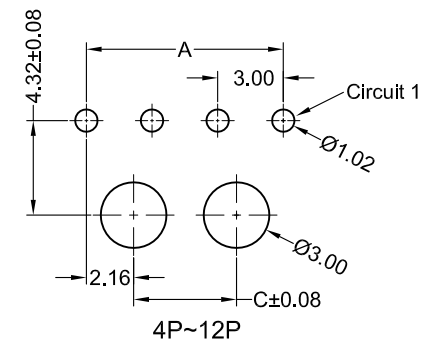
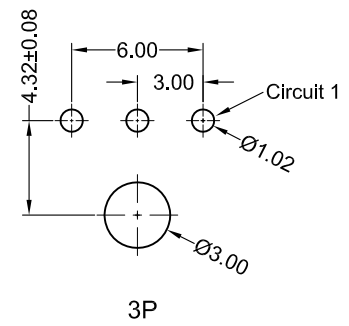
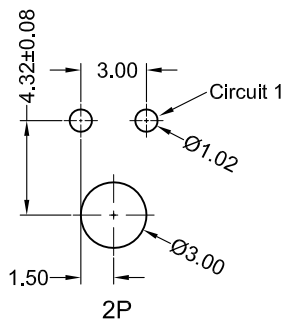
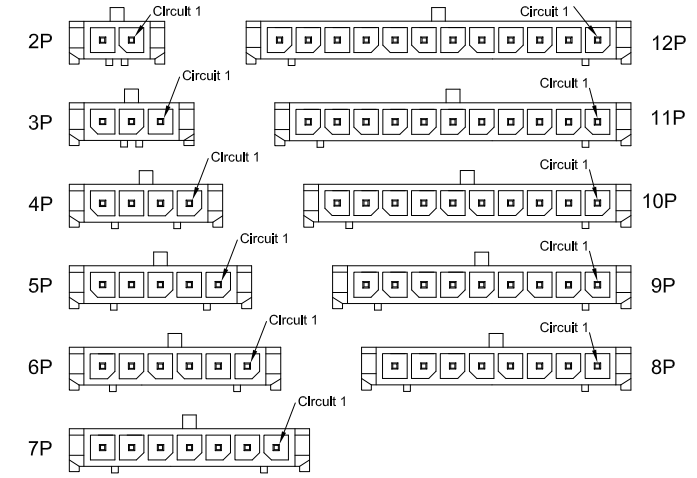
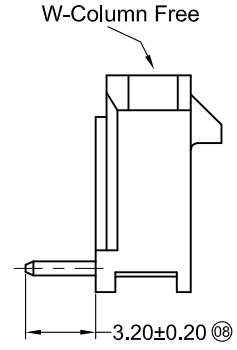
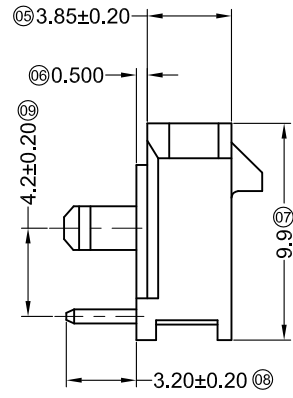
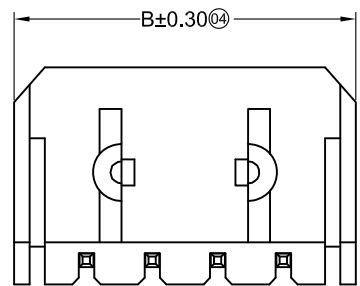

Recommended P.C.B Layout
General Tolerance±0.05

Poles	Dimensions(mm)			Poles	Dimensions(mm)		
	A	B	C		A	B	C
01	---	6.65	---	07	18.00	24.65	13.70
02	3.00	9.65	---	08	21.00	27.65	16.70
03	6.00	12.65	---	09	24.00	30.65	19.70
04	9.00	15.65	4.70	10	27.00	33.65	22.70
05	12.00	18.65	7.70	11	30.00	36.65	25.70
06	15.00	21.65	10.70	12	33.00	39.65	28.70

DATE	OLD REV	NEW REV	ECN	DESCRIPTION	CHECK	APPROVAL

GENERAL TOLERANCE	
.X	±0.30
.XX	±0.20
.XXX	±0.10
PROJECT	

东莞市思量连接器有限公司 DONGGUAN ADZL CONNECTORS CO.,LTD.			
APPROVAL	CHECK	DRAWN	DATE
Ken	Zhao Hong	Allen	2022/12/21

PART NO.			
3025WR-XXX-XXXXX-01			
TITLE			
3.00mm Crimp Style Connectors			
UNIT	SCALE	NUMBER	REV
MM	1:1	8	D

RoHS

TEL:0769-82285488

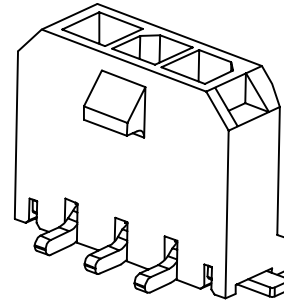
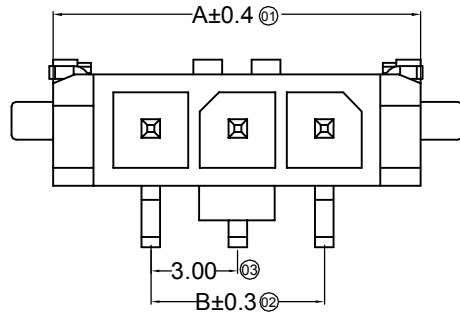

■ Specifications :

- Voltage rating: 250V AC / DC
- Current rating: 5A AC / DC
- Withstanding voltage: 1000V AC/minute
- Temperature range: -25°C~+85°C
- Insulation resistance: ≥1000MΩ
- Contact resistance: ≤10mΩ
- After environmental testing: ≤20mΩ

3025 W V S- XX D-LP XX XX
 ① ② ③ ④ ⑤ ⑥ ⑦ ⑧ ⑨

- ① Series No.
- ② Category: W-wafer
- ③ Welding Board Angle: V-180°
- ④ Welding Way: S-SMT
- ⑤ Row No.-Pin No.: XX-Single row
- ⑥ Special NO.: D-Solder Tabs
- ⑦ Material: LP-LCP 94V-0
- ⑧ Planting Category: SN-Bright tin plating
SW-Matte Tin plating
- ⑨ Color: Blank-natural color

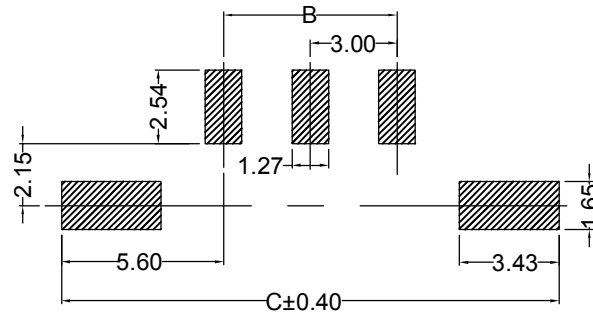
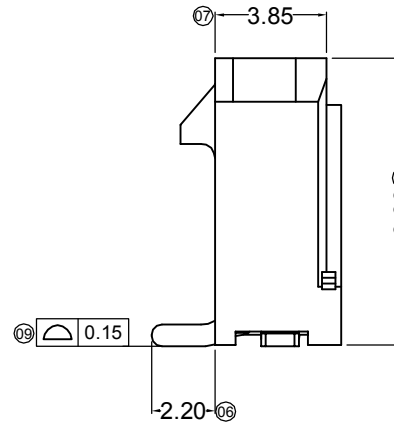
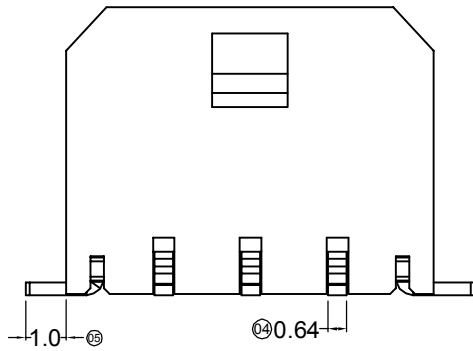

P.C.B. LAYOUT

Poles	Dimensions(mm)		
	A	B	C
02	9.70	3.00	14.20
03	12.70	6.00	17.20
04	15.70	9.00	20.20
05	18.70	12.00	23.20
06	21.70	15.00	26.20
07	24.70	18.00	29.20
08	27.70	21.00	32.20
09	30.70	24.00	35.20
10	33.70	27.00	38.20
11	36.70	30.00	41.20
12	39.70	33.00	44.20

3025WVS-XXD-LPSW	LCP UL 94V-0	Brass	Matte Tin Plated	Brass	Matte Tin Plated	3025H
3025WVS-XXD-LPSN	LCP UL 94V-0		Tin-Plated		Tin-Plated	
PART NO	Material	Material(Pin)	Finish(Pin)	Material (Solder Tabs)	Finish (Solder Tabs)	Mates With ADZL Housing

GENERAL TOLERANCE
 .X ±0.30
 .XX ±0.20
 .XXX ±0.10



PART NO. 3025WVS-XXD-LPXX

TITLE 3.00mm Crimp Style Connectors

APPROVAL CHECK DRAWN DATA

PROJECT

Ken Wisely He Allen 2007/05/03

UNIT SCALE NUMBER REV
 MM 1:1 A-106 E

DATE	OLD REV	NEW REV	ECN	DESCRIPTION	CHECK	APPROVAL
1						
2						
3						
4						

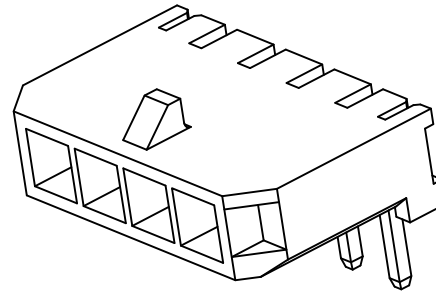
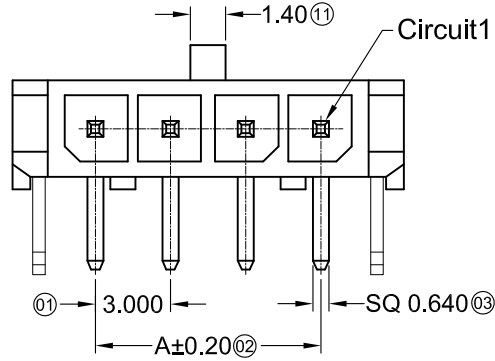

Specifications :

- Voltage rating: 250V AC / DC
- Current rating: 5A AC / DC
- Withstanding voltage: 1500V AC/minute
- Temperature range: -40°C~+105°C
- Insulation resistance: ≥1000MΩ
- Contact resistance: ≤10mΩ
- After environmental testing: ≤20mΩ

3025 W R X - XX C - XX SN XX
 ① ② ③ ④ ⑤ ⑥ ⑦ ⑧ ⑨

- ① Series No.
- ② Category: W-wafer
- ③ Welding Board Angle: R-90°
- ④ Welding Way: Blank-DIP
- ⑤ Row No.-Pin No.: XX-01P~12P
- ⑥ Plug the Pin & Special No.: C-The harpoon
- ⑦ Material: LP-LCP 94V-0 ; PT-PBT 94V-0
- ⑧ Planting Category: SN-Bright tin plating
- ⑨ Color: Blank-Natural Color Black

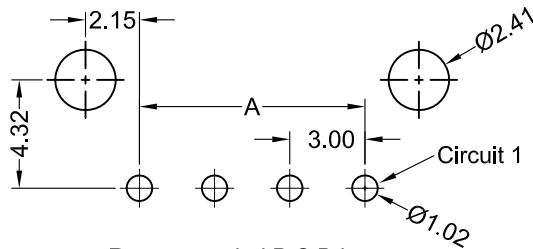
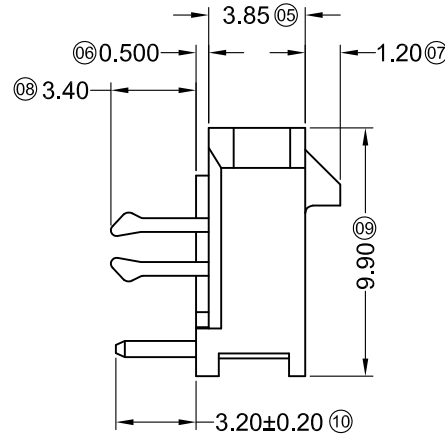
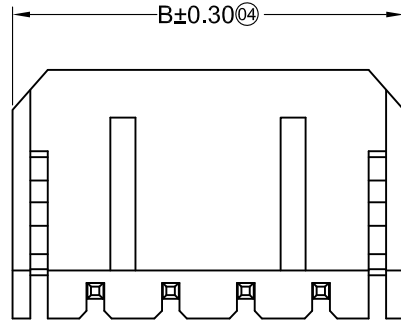

Recommended P.C.B Layout
 General Tolerance±0.05

Poles	Dimensions(mm)		Poles	Dimensions(mm)	
	A	B		A	B
01	---	6.65	07	18.00	24.65
02	3.00	9.65	08	21.00	27.65
03	6.00	12.65	09	24.00	30.65
04	9.00	15.65	10	27.00	33.65
05	12.00	18.65	11	30.00	36.65
06	15.00	21.65	12	33.00	39.65

3025WR-XXC-PTSN	PBT UL 94V-0	Brass	Tin-Plated	3025H
3025WR-XXC-LPSN	LCP UL 94V-0			
PART NO	Material	Material(Pin)	Finish(Pin)	Mates With ADZL Housing

GENERAL TOLERANCE

X	±0.30
.XX	±0.20
.XXX	±0.10



PART NO. 3025WR-XXC-XXSN

TITLE 3.00mm Crimp Style Connectors

APPROVAL CHECK DRAWN DATA

Ken Wisely He Allen 2015/05/05

UNIT	SCALE	NUMBER	REV
MM	1:1	A-089	A

DATE	OLD REV	NEW REV	ECN	DESCRIPTION	CHECK	APPROVAL	PROJECT
							

■ Specifications :

- Voltage rating: 250V AC / DC
- Current rating: 5A AC / DC
- Withstanding voltage: 1000V AC/minute
- Temperature range: -25°C~+85°C
- Insulation resistance: ≥1000MΩ
- Contact resistance: ≤10mΩ
- After environmental testing: ≤20mΩ

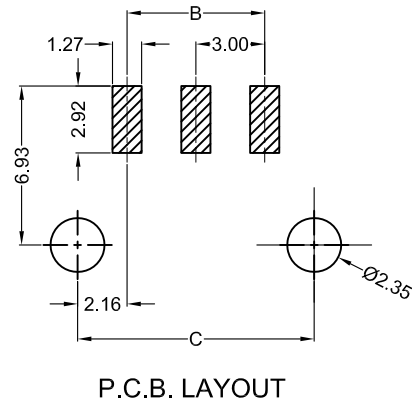

Poles	Dimensions (mm)		
	A	B	C
02	6.85	3.00	7.30
03	9.85	6.00	10.30
04	12.85	9.00	13.30
05	15.85	12.00	16.30
06	18.85	15.00	19.30
07	21.85	18.00	22.30
08	24.85	21.00	25.30
09	27.85	24.00	28.30
10	30.85	27.00	31.30
11	33.85	30.00	34.30
12	36.85	33.00	37.30

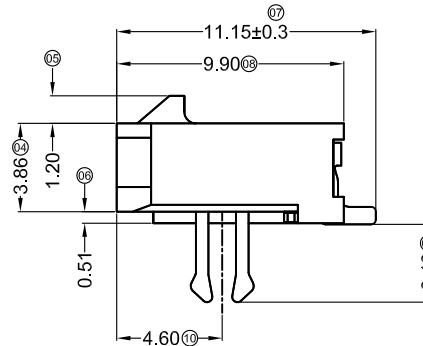
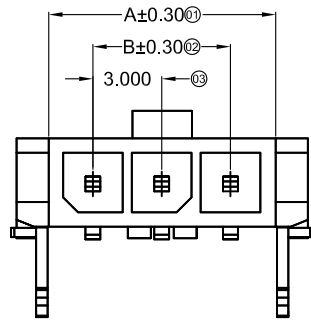
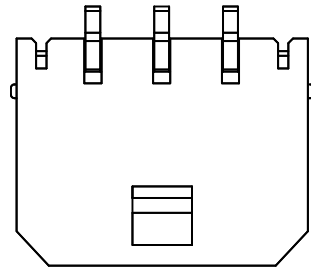

3025 W R S- XX C-LP SW XX
 ① ② ③ ④ ⑤ ⑥ ⑦ ⑧ ⑨

- ① Series No.
- ② Category: W-wafer
- ③ Welding Board Angle: R-90°
- ④ Welding Way: S-SMT
- ⑤ Row No.-Pin No. : XX-Single row
- ⑥ Special NO.: C-The harpoon
- ⑦ Material: LP-LCP 94V-0
- ⑧ Planting Category: SW-Fog Tin plating
- ⑨ Color: Blank-natural color

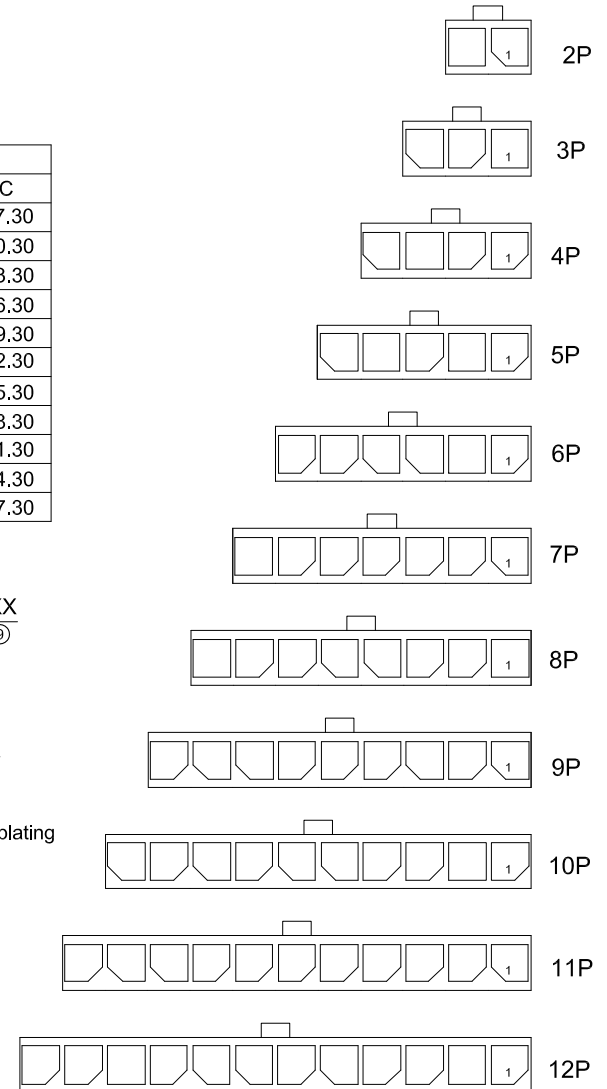

3025WRS-XXC-LPSW	LCP UL 94V-0	Brass	Matte Tin-Plated	Brass	Tin-Plated	3025H
PART NO	Material	Material(Pin)	Finish(Pin)	Material (Solder Tabs)	Finish (Solder Tabs)	Mates With ADZL Housing

							GENERAL TOLERANCE X ±0.30 .XX ±0.20 .XXX ±0.10				 思量连接器有限公司 ADZL CONNECTORS CO.,LTD				PART NO. 3025WRS-XXC-LPSW			
							APPROVAL CHECK DRAWN DATA				TITLE 3.00 mm Crimp Style Connectors							
DATE	OLD REV	NEW REV	ECN	DESCRIPTION	CHECK	APPROVAL	PROJECT	Ken	Wisely He	Allen	2017/05/03	UNIT MM	SCALE 1:1	NUMBER A-106	REV E			

RoHS  Lead-free

TEL:0769-82285488

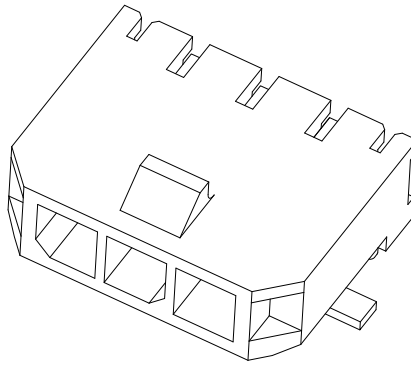
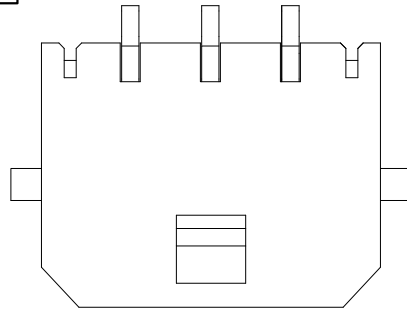

Specifications :

- Voltage rating: 250V AC / DC
- Current rating: 5A AC / DC
- Withstanding voltage: 1000V AC/minute
- Temperature range: -25°C~+85°C
- Insulation resistance: ≥1000MΩ
- Contact resistance: ≤10mΩ
- After environmental testing: ≤20mΩ

3025 W R S- XX D-LP SW XX
 ① ② ③ ④ ⑤ ⑥ ⑦ ⑧ ⑨

- ① Series No.
- ② Category: W-wafer
- ③ Welding Board Angle: R-90°
- ④ Welding Way: S-SMT
- ⑤ Row No.-Pin No.: XX-Single row
- ⑥ Special NO. :D-Solder Tabs
- ⑦ Material: LP-LCP 94V-0
- ⑧ Planting Category: SW-Matte Tin plating
- ⑨ Color: Blank-natural color

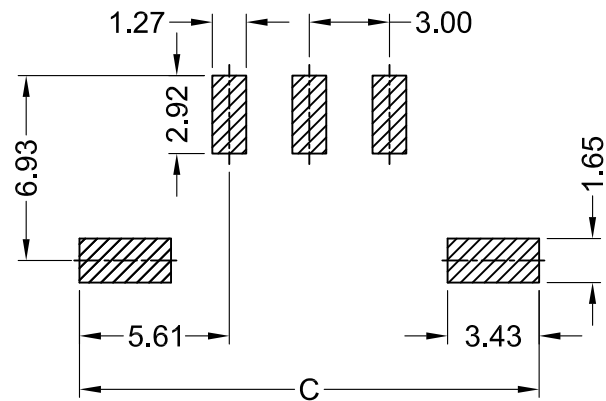
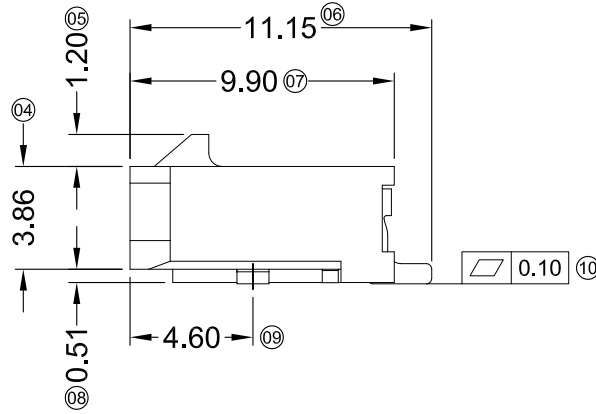
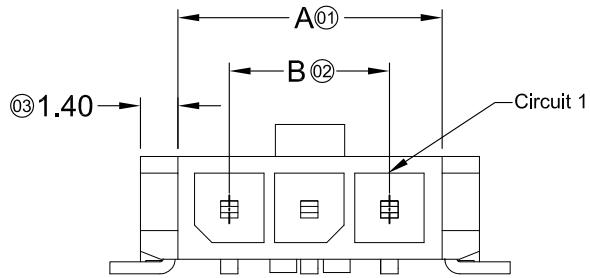

P.C.B. LAYOUT

Poles	Dimensions		
	A	B	C
2	6.85	3.00	14.20
3	9.85	6.00	17.20
4	12.85	9.00	20.20
5	15.85	12.00	23.20
6	18.85	15.00	26.20
7	21.85	18.00	29.20
8	24.85	21.00	32.20
9	27.85	24.00	35.20
10	30.85	27.00	38.20
11	33.85	30.00	41.20
12	36.85	33.00	44.20

3025WRS-XXD-LPSW			Matte Tin Plating	Brass	Matte Tin-Plated	3025H
PART NO	Material	Material(Pin)	Finish(Pin)	Material (Solder Tabs)	Finish (Solder Tabs)	Mates With ADZL Housing

GENERAL TOLERANCE
 X ±0.30
 .XX ±0.20
 .XXX ±0.10

 思量连接器有限公司
 ADZL CONNECTORS CO.,LTD

PART NO.
 3025WRS-XXD-LPXXX

TITLE
 3.00 mm Crimp Style Connectors

PROJECT

APPROVAL	CHECK	DRAWN	DATA
Ken	Wisely He	Allen	2007/05/03

UNIT	SCALE	NUMBER	REV
MM	1:1	A-053	E

DATE	OLD REV	NEW REV	ECN	DESCRIPTION	CHECK	APPROVAL

RoHS

WWW.ADZLCONN.COM

TEL:0769-82285488

■ Specifications :

- Voltage rating: 250V AC / DC
- Current rating: 5A AC / DC
- Withstanding voltage: 1000V AC/minute
- Temperature range: -40°C~+105°C
- Insulation resistance: ≥1000MΩ
- Contact resistance: ≤10mΩ
- After environmental testing: ≤20mΩ

3025 H F-XX XX-XX XX

① ② ③ ④ ⑤ ⑥ ⑦

- ① Series No.
- ② Category: H-HSG
- ③ Welding Board Angle: F-Female HSG
- ④ Row No.-Pin No.: XX-02P~12P
- ⑤ Plug the Pin & special No.: I-Without Ears
G-With Ears
- ⑥ Material: N2-PA66 94V-2; N0-PA66 94V-0
- ⑦ Color: Blank-Black

Poles	Dlmenstions(mm)			
	A	B	C	D
02	3.00	6.90	7.21	10.89
03	6.00	9.90	10.21	13.89
04	9.00	12.90	13.21	16.89
05	12.00	15.90	16.21	19.89
06	15.00	18.90	19.21	22.89
07	18.00	21.90	22.21	25.89
08	21.00	24.90	25.21	28.89
09	24.00	27.90	28.21	31.89
10	27.00	30.90	31.21	34.89
11	30.00	33.90	34.21	37.89
12	33.00	36.90	37.21	40.89

3025HF-XXG-N2	Nylon 66 94V-2	Natural Color	3025TM	3025HM	With Ears
3025HF-XXG-N0	Nylon 66 94V-0	Natural Color			
3025HF-XXI-N2	Nylon 66 94V-2	Natural Color	3025TM	3025HM	Without Ears
3025HF-XXI-N0	Nylon 66 94V-0	Natural Color			
PART NO	Material	Color	Suitable ADZL Terminal	Mates With ADZL Housing	Note

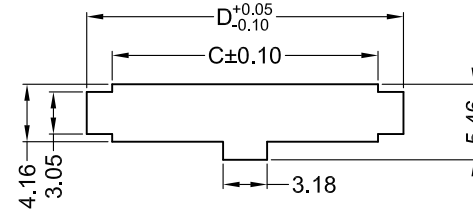

With Ears Recommended P.C.B Layout
General Tolerance ±0.05 T=1.60~2.40mm

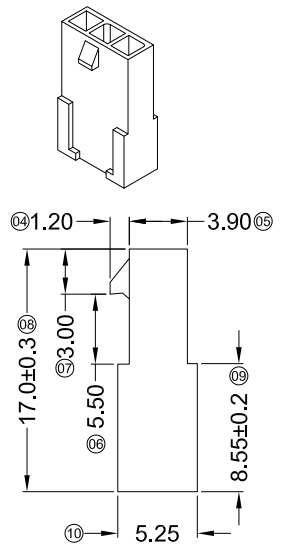
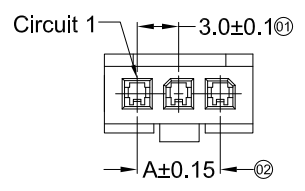
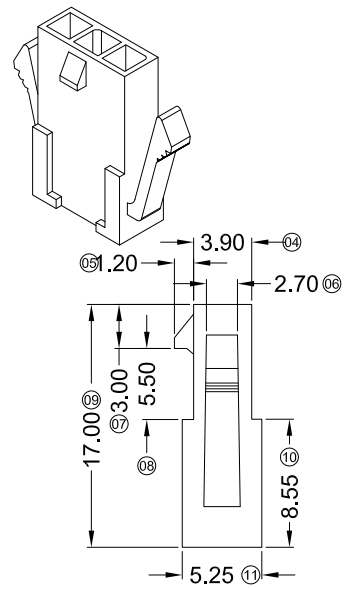
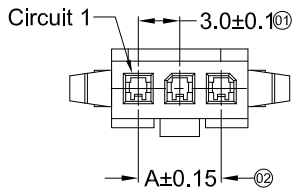
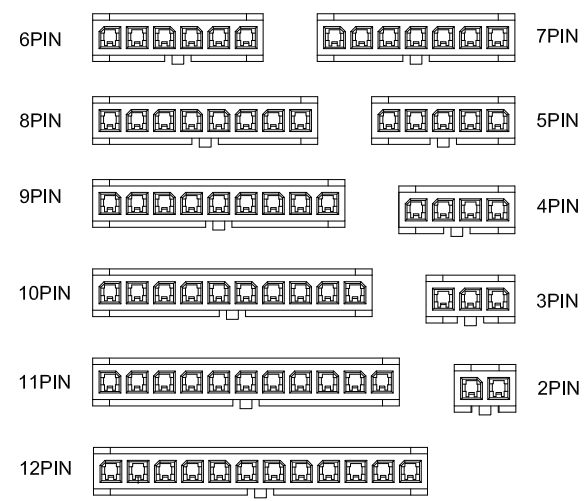

Without Ears

GENERAL TOLERANCE
.X ±0.30
.XX ±0.20
.XXX ±0.10

ADZL 东莞市思量连接器有限公司
DONGGUAN ADZL CONNECTORS CO.,LTD.

APPROVAL Ken CHECK Zhao Hong DRAWN Allen DATA 2024/05/18

PART NO. 3025HF-XXX-XX
TITLE 3.00 mm Crimp Style Connectors
UNIT MM SCALE 1:1 NUMBER REV

DATE OLD REV NEW REV ECN DESCRIPTION CHECK APPROVAL PROJECT

1 2 3 4 5 6 7 8

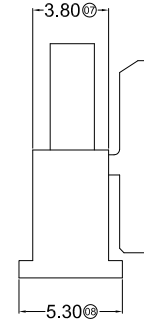
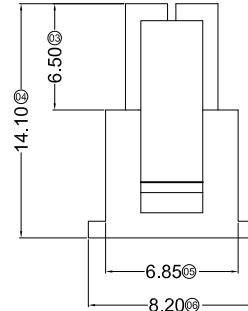
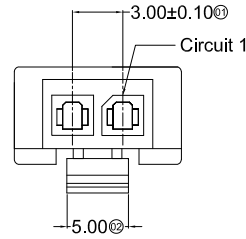
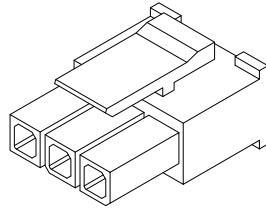
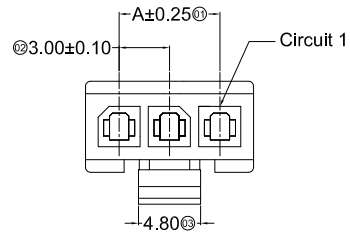

■ Specifications :

- Voltage rating: 250V AC / DC
- Current rating: 5A AC / DC
- Withstanding voltage: 1000V AC/minute
- Temperature range: -40°C~+105°C
- Insulation resistance: ≥1000MΩ
- Contact resistance: ≤10mΩ
- After environmental testing : ≤20mΩ

3025 H M-XX X-XX XX

① ② ③ ④ ⑤ ⑥ ⑦

- ① Series No.
- ② Category: H-HSG
- ③ Welding Board Angle: M-Male HGS
- ④ Row No.-Pin No.: XX-02P~12P
- ⑤ Plug the Pin & special No.
- ⑥ Material: N2-PA66 94V-2 N0-PA66 94V-0
- ⑦ Color: Blank-Black

Poles	Dimensions (mm)		Poles	Dimensions (mm)	
	A	B		A	B
03	6.00	9.85	08	21.00	24.85
04	9.00	12.85	09	24.00	27.85
05	12.00	15.85	10	27.00	30.85
06	15.00	18.85	11	30.00	33.85
07	18.00	21.85	12	33.00	36.85

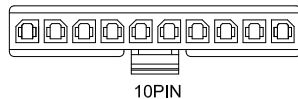
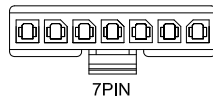
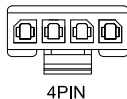
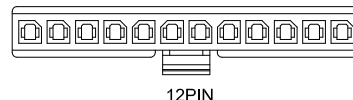
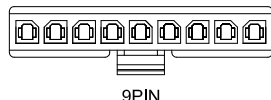
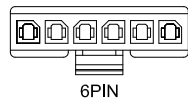
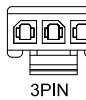
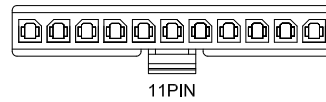
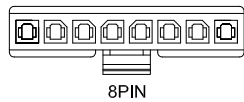
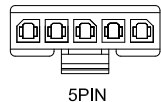
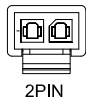

3025HM-XX-XX	Nylon 66 94 V-2/V-0	3025TF	3025W
PART NO	Material	Suitable ADZL Terminal	Mates With ADZL Wafer

GENERAL TOLERANCE

.X	±0.30
.XX	±0.20
.XXX	±0.10

 东莞市思量连接器有限公司
DONGGUAN ADZL CONNECTORS CO.,LTD.

PART NO. 3025HM-XX-XX

TITLE 3.00 mm Crimp Style Connectors



APPROVAL	CHECK	DRAWN	DATA
Ken	Zhao Hong	Allen	2024/05/18

UNIT	SCALE	NUMBER	REV
MM	1:1	8	

DATE	OLD REV	NEW REV	ECN	DESCRIPTION	CHECK	APPROVAL

RoHS

TEL:0769-82285488

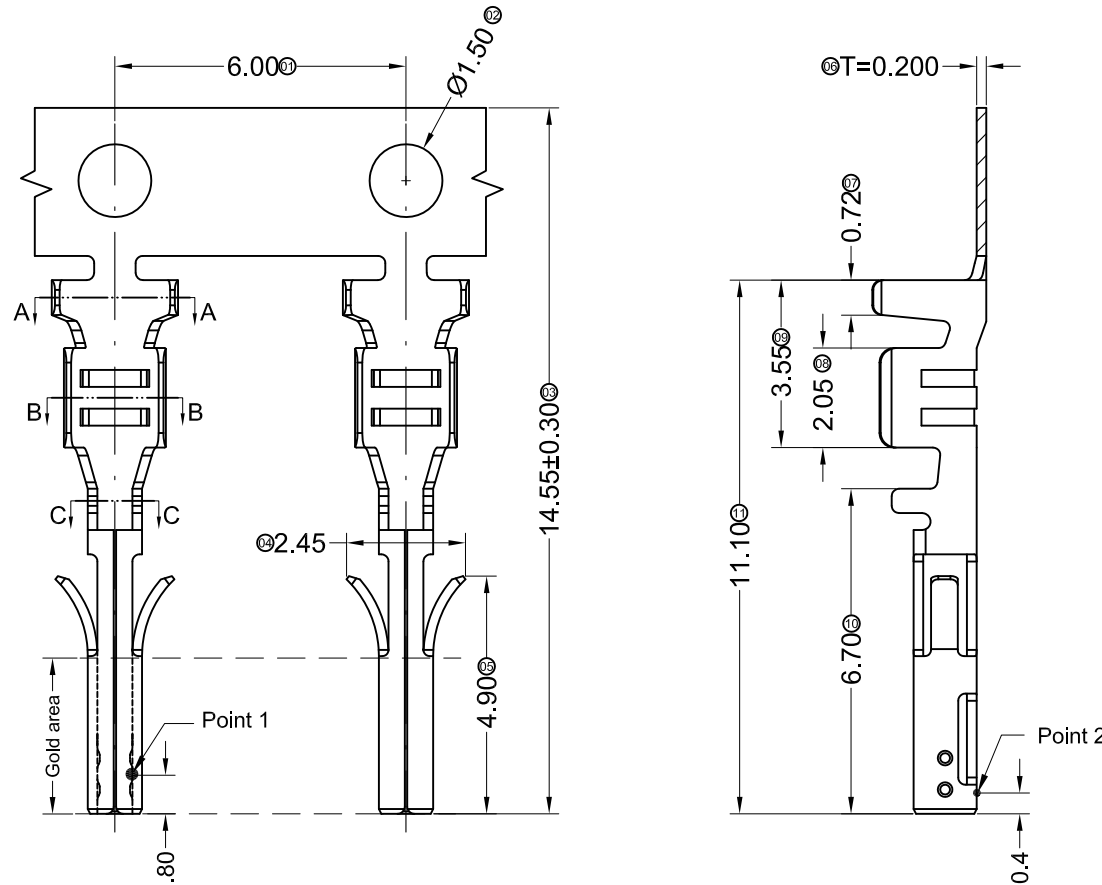

■ Specifications :

- Voltage rating: 250V AC / DC
- Current rating: 5A AC / DC
- Withstanding voltage: 1000V AC/minute
- Temperature range: -40°C~+105°C
- Insulation resistance: ≥1000MΩ
- Contact resistance: ≤10mΩ
- After environmental testing: ≤20mΩ

3025 T F-P XX X-X
 ① ② ③ ④ ⑤ ⑥ ⑦

- ① Series Number
- ② Category: T-terminal
- ③ Shape: F-Female Terminal
- ④ Material: P-Phosphor bronze
- ⑤ Plating style:
 G30- Contact point gold 30u "(inside) Gold area1u"(outside)
 Other area Ni 20u" Min
- G15- Contact point gold 15u "(inside) Gold area1u"(outside)
 Other area Ni 20u" Min
- G01-Contact Area Gold Flash
- SN-Bright tin plating
- ⑥ Plating method:
 Blank-Stamping before plating
- ⑦ Mold No./Mark/Special No.

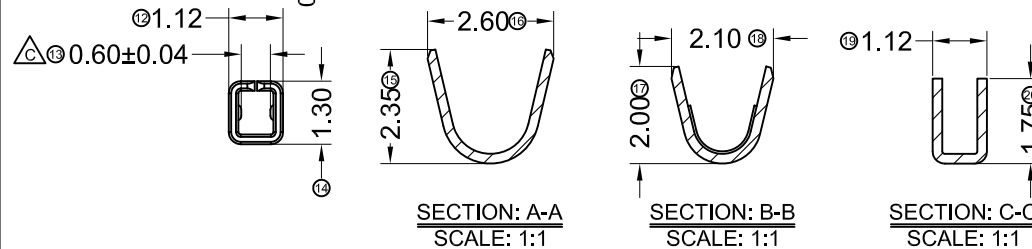
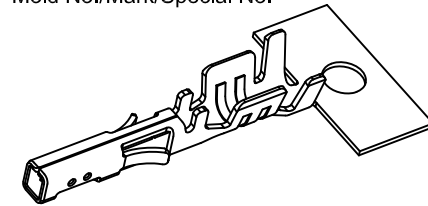

3025TF-PG30	Phosphor Bronze	AWG#20-24	1.85mm(Max)	Stamping Before Pating:20u" Min. Ni; Contact Area Gold:30u" Min.	Point 1	3025HM
3025TF-PG15				Stamping Before Pating:20u" Min. Ni; Contact Area Gold:15u" Min.		
3025TF-PG01				Stamping Before Pating:50u" Min. Ni; Contact Area Gold Flash	Point 2	
3025TF-PSN				Stamping Before Pating:50u" MIN. Ni; 100u" MIN. Sn		
PART NO	Material	Wire Range	Insulation O.D.	Finish	Plating measuring point	Used In ADZL Housing point

				GENERAL TOLERANCE				ADZL 思量连接器有限公司 ADZL CONNECTORS CO.,LTD				PART NO. 3025TF-PXXX			
				.X ±0.30				APPROVAL				TITLE 3.00mm Crimp Style Connectors			
				.XX ±0.20								CHECK Wisely He			
				.XXX ±0.10				DRAWN Allen				SCALE 1:1			
DATE				PROJECT				DATA 2015/03/31				NUMBER A-014			
OLD REV				PROJECT				Ken				REV C			
NEW REV				PROJECT				Wisely He				REV C			
ECN				PROJECT				Allen				REV C			
DESCRIPTION				PROJECT				2015/03/31				REV C			
CHECK				PROJECT				Ken				REV C			
APPROVAL				PROJECT				Wisely He				REV C			

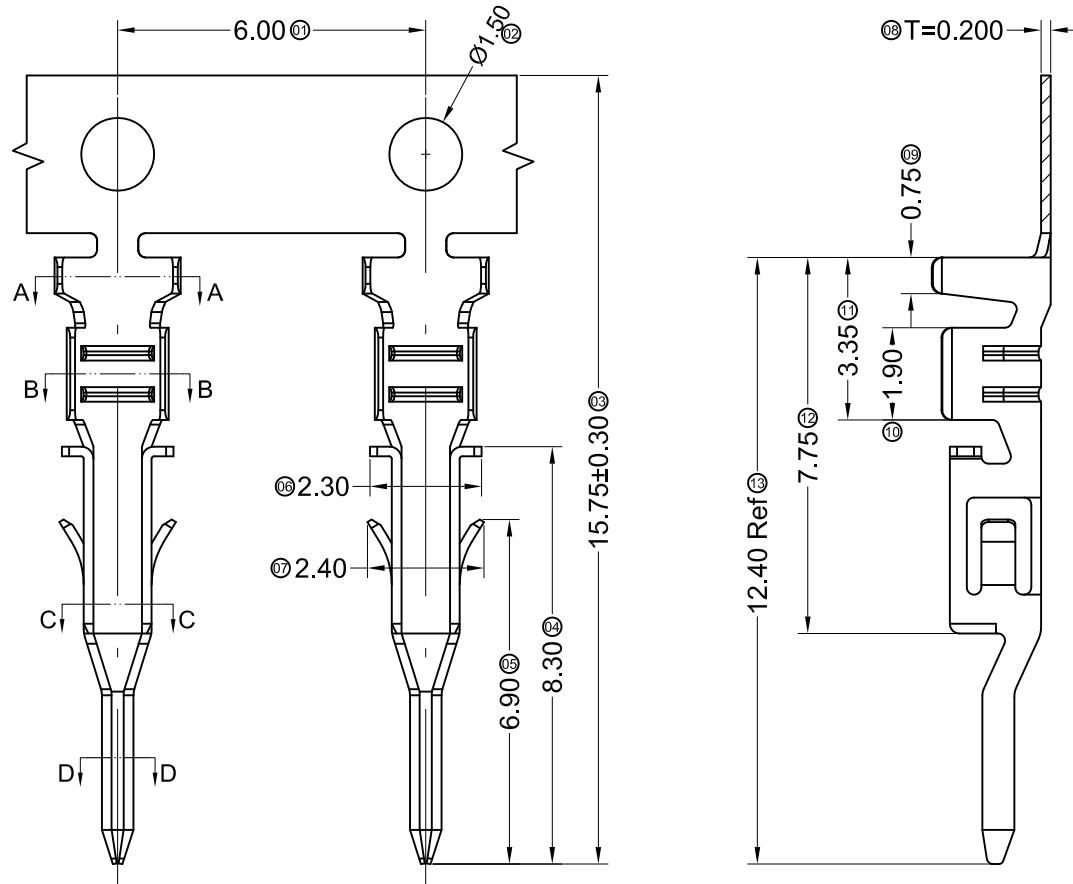

■ Specifications :

- Voltage rating: 250V AC / DC
- Current rating: 5A AC / DC
- Withstanding voltage: 1000V AC/minute
- Temperature range: -40°C~+105°C
- Insulation resistance: ≥1000MΩ
- Contact resistance: ≤10mΩ
- After environmental testing: ≤20mΩ

3025 T M-P XX X-X

① ② ③ ④ ⑤ ⑥ ⑦

- ① Series Number
- ② Category: T-terminal
- ③ Shape: M-male
- ④ Material: P-Phosphor bronze
- ⑤ Plating style: SN-Bright tin plating
- ⑥ Plating method: Blank-Stamping before plating
- ⑦ Mold No./Mark/Special No.

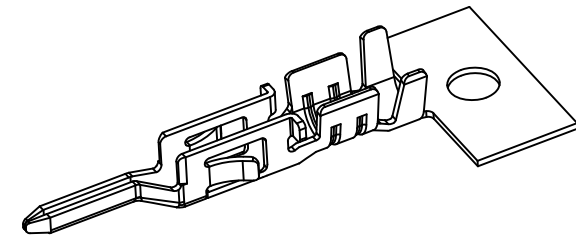

SECTION: A-A
SCALE: 1:1

SECTION: B-B
SCALE: 1:1

SECTION: C-C
SCALE: 1:1

SECTION: D-D
SCALE: 1:1

3025TM-PSN	Phosphor Bronze	AWG#20-24	1.85mm(Max)	Stamping Before Plating;30u" Ni Min;70u"Sn Min	3025HF
PART NO	Material	Wire Range	Insulation O.D.	Finish	Used In adzl Housing

				GENERAL TOLERANCE				ADZL 思量连接器有限公司 ADZL CONNECTORS CO.,LTD				PART NO. 3025TM-PSN			
				X ±0.30				APPROVAL				TITLE 3.00mm Crimp Style Connectors			
				.XX ±0.20				CHECK				UNIT			
				.XXX ±0.10				DRAWN				SCALE			
DATE				PROJECT				DATA				NUMBER			
OLD REV				PROJECT				Ken				A-014			
NEW REV				PROJECT				Wisely He				REV			
ECN				PROJECT				Allen				D			
DESCRIPTION				PROJECT				2015/04/10							
CHECK				PROJECT											
APPROVAL				PROJECT											